

260C Walk-Behind Greens Mower

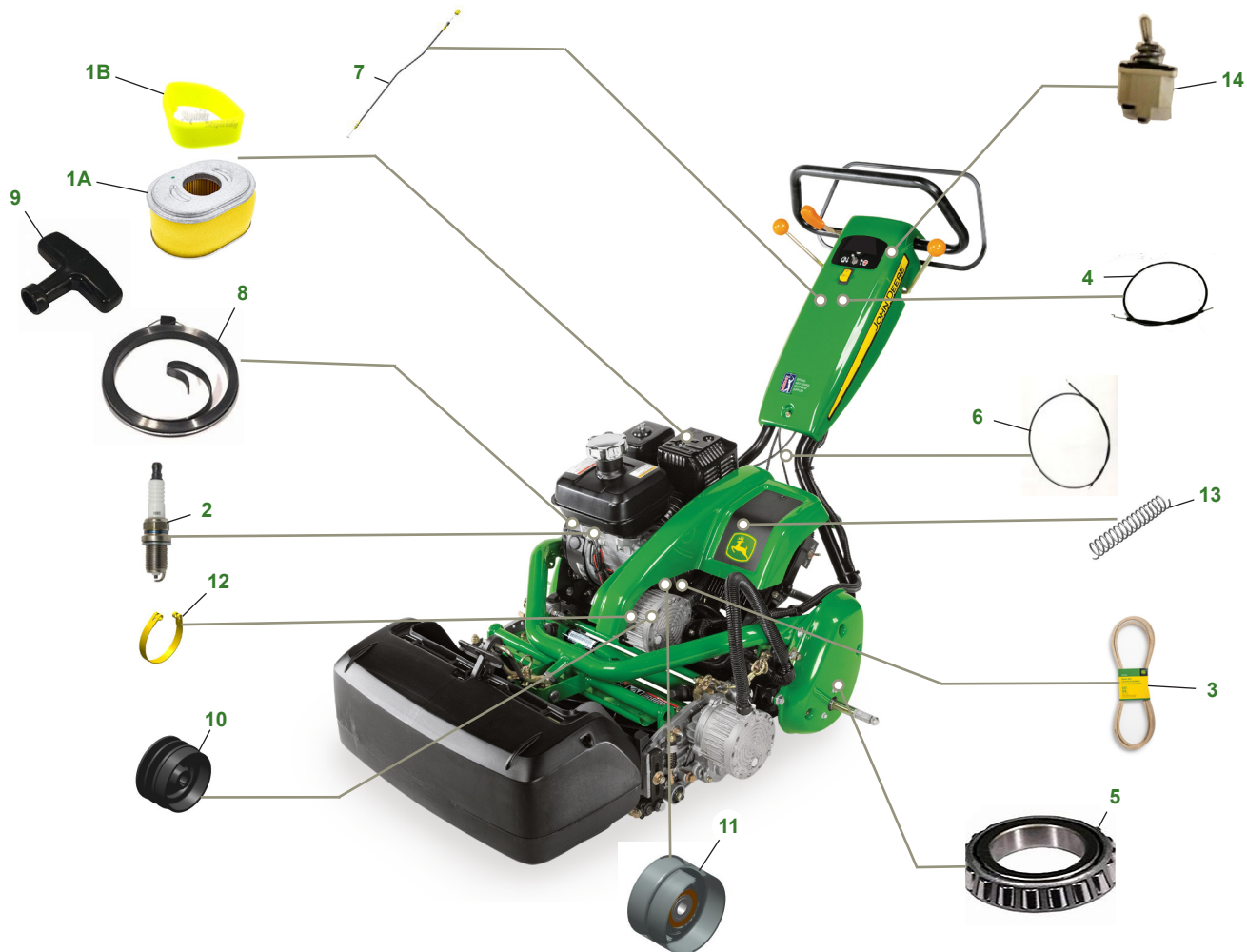

Key	Part No.	Description	Key	Part No.	Description
1A	AM123909	AIR FILTER - SECONDARY	8	M128283	SPRING
1B	MIU11464	AIR FILTER - PRIMARY	9	M128285	HANDLE
2	M128206	SPARK PLUG	10	MT1066	PULLEY
3	AMT2800	BELT - SET OF 2	11	MT1074	BELT IDLER
4	AMT1680	PUSH PULL CABLE - THROTTLE	12	AMT820	BRAKE BAND
5	JD10181	BEARING - CHAIN DRIVE	13	MT1200	COMPRESSION SPRING
6	AMT2742	BRAKE CABLE	14	AT106154	TOGGLE SWITCH
7	AMT2741	CLUTCH CABLE			

Parts Needed in First 300 hours of Operation

Qty	Part No.	Item	Capacity	Interval In Hours
7	TY22029	Turf-Gard™ 10W-30 Engine Oil	0.6 L (0.63 qt)	20/50/100/150/200/250/300
1	TY6354	Hy-Gard™ Transmission Oil	0.14 L (0.3 qt)	50
1	MIU11464	Air Cleaner Primary	1	300
1	M128206	Spark Plug	1	300
1	TY6341	Multi Purpose SD Polyurea Grease		As Needed
1	TY25083	John Deere Special Purpose Golf & Turf Cutting Unit Grease (Cutting Unit and Cutting Unit Attachments)		As Needed

*Refer to Operators Manual for service intervals if using Bio Hy-Gard.