

FILTER OVERVIEW WITH SERVICE INTERVALS AND CAPACITIES

9000 Series Tractors - 9100, 9200, 9300, 9400

ENGINE

SECONDARY AIR FILTER (9100-9400) – [RE63932](#)

Do Not clean.
Replace with every second or third primary filter replacement.

ENGINE

PRIMARY AIR FILTER (9100-9400) – [AH148880](#)

Replace annually, after six cleanings or as indicated.
(Interval may vary according to operating conditions.)

ENGINE

OIL FILTER (9100) – [DZ101880](#)

OIL FILTER (9200-9400) – [RE58935](#)

Initial oil and filter change at 100 hours and then after every 250 hours.

Scheduled interval of 250 hours can be extended to 375 hours if John Deere Plus-50 oil and John Deere filter are used.

(Click here for [capacity](#))

TRANSMISSION

OIL FILTER (9100-9400) – [RE174130](#)

Initially replace after 100 hours and then after every 750 hours or as required. (12 Speed & 24 Speed Transmission)

Replace every after 1500 hours. (PST Transmission)

(Click here for [capacity](#))

ENGINE

PRE-FUEL/WATER SEPARATOR (9100) – [RE508633](#)

FUEL PRIMARY (9100) – [AR86745](#)

Replace after every 750 hours.
(Interval may vary according to operating conditions.)

PRIMARY FUEL FILTER (9200-9400; early two-filter style) – [RE502203](#)

SECONDARY FUEL FILTER (9200-9400; early two-filter style) – [RE506428](#)

9200 up to engine serial-no. -3713

9300/9400 up to engine serial-no. -10637

Replace after every 250 hours.

(Interval may vary according to operating conditions.)

FUEL FILTER

(9200-9400; single filter system) – [RE507284](#)

9200 from engine serial no. 3714 up to 29999

9300/9400 from engine serial no. 10638 up to 29999

FUEL FILTER

(9200-9400; single filter system) – [RE507284](#)

9200/9300/9400 from engine serial no. 30000

Replace after every 750 hours.

(Interval may vary according to operating conditions.)

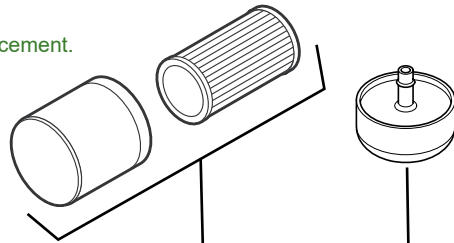

ENGINE

FUEL TANK VENT FILTER

[RE52504](#)

Replace every after 750 hours.

(Interval may vary according to operating conditions.)

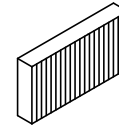
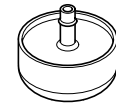
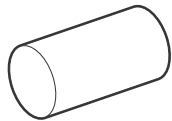

CAB

RECIRCULATION AIR FILTER

(9100-9400) – [RE70742](#)

9100 up to engine serial no. 030000

9200 up to engine serial no. 001674

9300 up to engine serial no. 001752

9400 up to engine serial no. 002395

Clean after every 250 hours and replace annually or as required.

(Interval may vary according to operating conditions.)

ACTIVATED CARBON RECIRCULATION

AIR FILTER (9100-9400) – [RE199682](#)

Do Not clean.

Replace annually or as required.

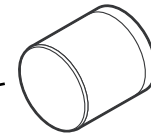

CAB

FRESH AIR FILTER, HEAVY DUTY (9100-9400) –

[RE67829](#)

AIR FILTER, STANDARD (9100-9400) – [RE24619](#)

Clean after every 250 hours and replace annually or as required.

(Interval may vary according to operating conditions.)

CAB

ACTIVATED CARBON AIR FILTER (9100-9400) –

[RE199681](#)

Do Not clean.

Replace annually or as required.

ENGINE

AIR, HYDRAULIC RESERVOIR FILTER (9100-9200) –

[AT101565](#)

Replace annually and as required.

(Click here for [capacity](#))

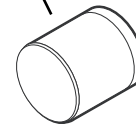

HYDRAULICS

AXLE LUBE FILTER, CLEANUP (9100-9400) –

[AL118036](#)

AXLE LUBE FILTER

(9100-9400) – [AL221066](#)

Initially replace after 100 hours and then every 750 hours or as required.

(Click here for [capacity](#))

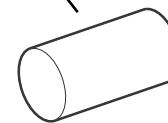

HYDRAULICS

OIL HYDRAULIC (9100-9400) – [RE174130](#)

Replace after every 750 hours, as indicated or as indicated.

(Interval may vary according to operating conditions.)

(Click here for [capacity](#))



JOHN DEERE

Genuine Parts and Service

CAPACITIES

9000 Series Tractors - 9100, 9200, 9300, 9400

CAPACITIES (Approximate):

Fuel Tank:

..... 969 L (256 gal)

Cooling System:

Cool-Gard™

9100..... 58 L (14.5 gal)

9200-9300-9400 60 L (16 gal)

Crankcase:

Plus-50™

9100..... 30 L (8 gal)

9200-9300-9400 42 L (11 gal)

12 and 24 Speed Transmission:

Hy-Gard™

Without PTO (Capacity Includes Axles)..... 129 L (34.5 gal)

With PTO (Capacity Includes Axles)..... 131 L (35 gal)

Powershift Transmission:

Hy-Gard™

Without PTO 51 L (13.5 gal)

With PTO 53 L (14 gal)

Axles 102 L (27 gal)

Hydraulic System:

Hy-Gard™

Without Hitch 98 L (26 gal)

With Hitch 102 L (27 gal)

[Return to Filter Overview](#)

